

# PRODUCT DATA SHEET

## XYLASTIC®-500

### DESCRIPTION

**XYLASTIC®-500** is single-component bitumen-modified, moisture curing polyurethane waterproofing membrane.

**XYLASTIC®-500** is highly elastic, seamless with excellent crack bridging properties.

### RECOMMENDED FOR:

- Roof Terraces
- Plaza Decks
- Pedestrian Concourses
- Planter Boxes
- Tunnels and Subway Structures
- Foundation
- Retaining Walls
- Swimming Pool

### ADVANTAGES

- ✓ Resist extreme hydrostatic pressure
- ✓ Excellent crack bridging properties
- ✓ Paintable
- ✓ Easy to apply
- ✓ Fast curing
- ✓ Excellent adhesion to concrete, wood, metal, etc.

### PACKAGING

**XYLASTIC®-500** is available in 20kg container.

### STORAGE

**XYLASTIC®-500** must be stored in cool, dry place. The shelf life is 9 months from date of production in unopened original packaging.

### COVERAGE

Under normal conditions, the coverage rate for **XYLASTIC®-500** is 0.50kg/m<sup>2</sup> per coat.

### TECHNICAL DATA

- Average ultimate tensile strength: 6N/mm<sup>2</sup> (with fiber mesh reinforcement) (ASTM D638)
- Average elongation at Break: 500% (ASTM D638)
- Minimum recovery: 90% (ASTM D412-98a)
- Solid content: 70% by volume
- Moisture vapour permeability: 9.5gm/m<sup>2</sup> (24hours) (ASTM E96-00)
- Cracks Bridging Test: Pass (No loss of bond cracking exhibited) (ASTM C1305-08)
- Water absorption: 2.4% (ASTM D570-98)
- Shore Hardness: A65
- Chemical resistance: unaffected by mild acids, alkalis and water borne salts. Does not biodegrade.
- Softening point: 83.8°C (ASTM-D 648-07)



Certification No.: 032-106-0844

**ENVIRONMENTALLY  
PREFERRED COATING**

XYLASTIC®-500 XYLASTIC®-500 XYLASTIC®-500 XYLASTIC®-500 XYLASTIC®-500

# XYLASTIC®-500

## APPLICATION PROCEDURES

### 1. SURFACE PREPARATION

Concrete surface to be treated shall have light steel-trowel finish which is free of dust, oil and other contaminants.

The substrate must be fully cured and sound.

Repair crack line, honeycomb with suitable repair method.

### 2. MIXING

Stir **XYLASTIC®-500** thoroughly by electric stirrer (approximately 350 - 400 RPM) for 1 - 2 minutes and let the entrapped air to escape.

### 3. APPLICATION

**XYLASTIC®-500** can be applied by trowel, squeegee, roller, brush or by airless spray equipment.

#### Primer Coat

Mix one part **XYLASTIC®-500** with one part water and apply at 0.30kg/m<sup>2</sup>.

#### Base Coat

Apply 1st coat **XYLASTIC®-500** at 0.50kg/m<sup>2</sup>.

Apply 2nd coat **XYLASTIC®-500** at 0.50kg/m<sup>2</sup>.

#### Optional:

Heavy duty fiber mesh reinforcement may be laid between 1st and 2nd coat **XYLASTIC®-500** to increase the tensile strength and toughness.

#### Optional:

3rd coat **XYLASTIC®-500** to be applied at 0.50kg/m<sup>2</sup> in areas of extreme hydrostatic pressure or high thermal stresses is anticipated.

### 4. MECHANICAL FIXER

Mechanical fixer shall be installed at 400mm to 600mm grid to hold steel wire mesh for cement/sand plaster at Swimming Pool Wall.

### 5. CURING

Working time between coat	20°C	6 - 8 hours
	30°C	5 - 6 hours
Rain resistant		After 5 hours

### LIMITATION

- Not subject to traffic and must be protected.
- Do not apply with high consumption than recommended.

### TECHNICAL SERVICES

For more information, alternative application methods or information concerning the compatibility with other products or technology, contact the Technical Department of the Distributor.

### REPAIRS

If damaged, **XYLASTIC®-500** can be repaired with applying additional coating with the same product. Clean the damaged area prior to recoating.

### PRECAUTIONS

Wear protective gloves during application. If in contact with skin, wash thoroughly with water and soap. Flush immediately with plenty of water if in contact with eyes and seek medical attention without delay. Harmful if swallowed. Keep away from heat and open flame.

# XYLASTIC®-500

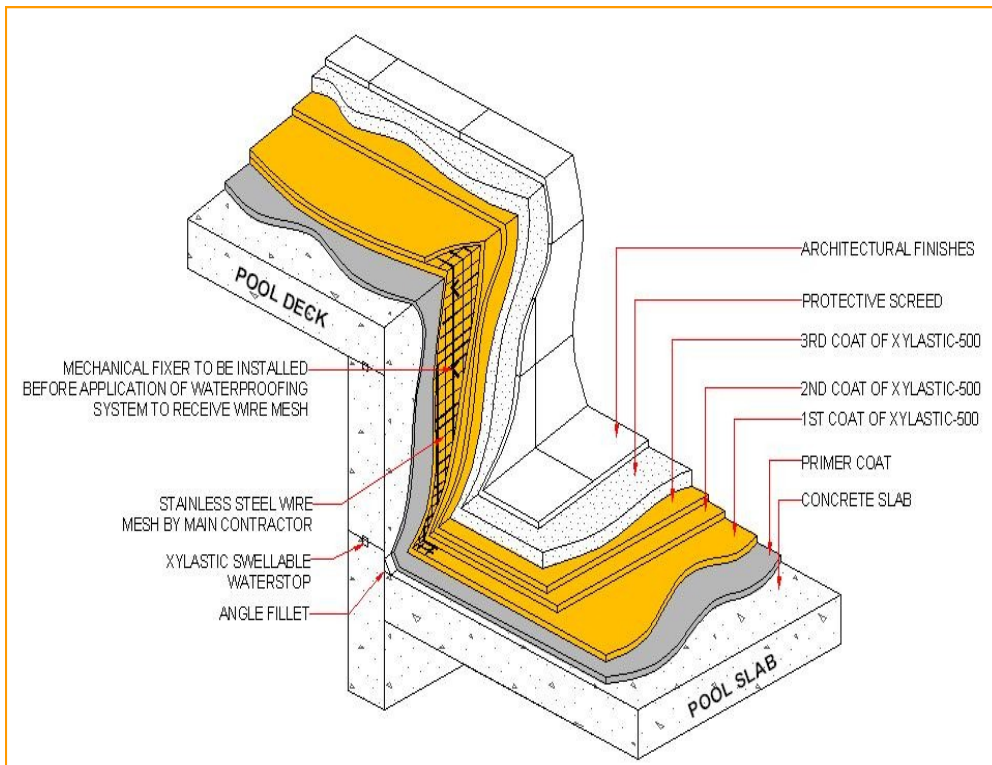
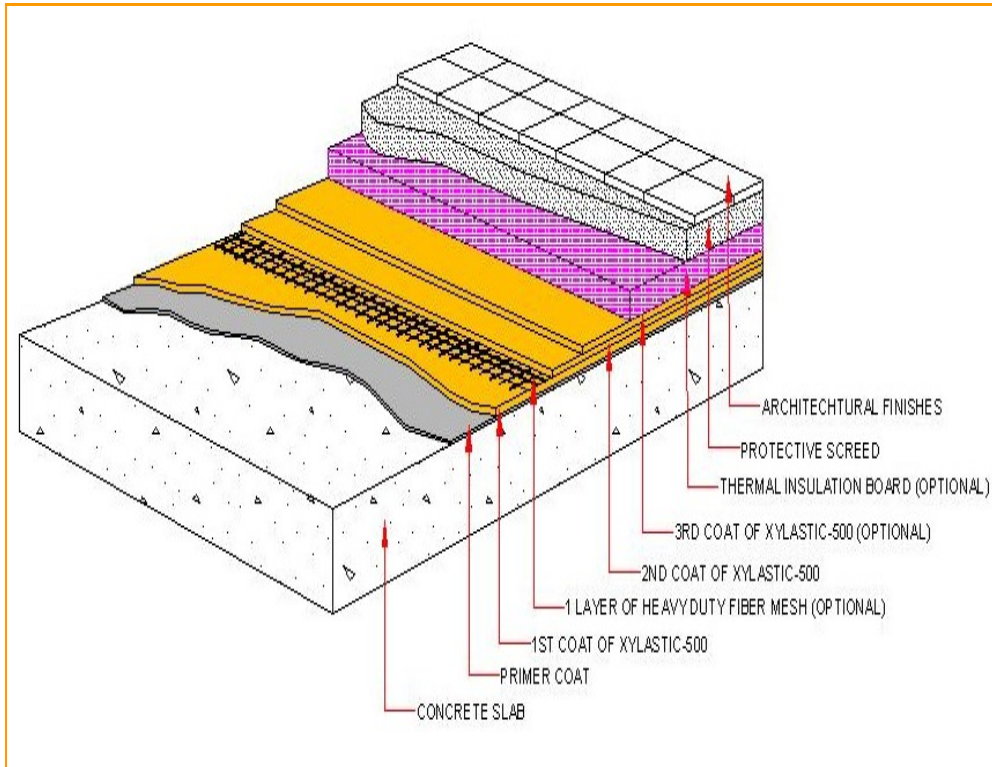

XYLASTIC®-500 XYLASTIC®-500 XYLASTIC®-500 XYLASTIC®-500

## **XYLASTIC®-500**

### **CEMENT AND SAND PROTECTIVE PANELS FOR FOOT TRAFFIC**

Over the **XYLASTIC®-500** membrane, lay a minimum of 50mm thick cement and sand screed consisting of one part of cement and three parts of sand by volume, reinforce with BRC wire mesh or equivalent and construct into square panels of 2m x 2m by forming groove joints of 10mm x 10mm and seal with sealant.

### **THERMAL INSULATION (OPTIONAL)**

For areas which require thermal insulation, insulation board such as extruded or expanded polystyrene 25mm to 50mm thick shall be used, with density of 32 kg/m<sup>3</sup> depending on the Thermal Conductivity required.

### **POLYSTYRENE PROTECTIVE BOARD BEFORE BACKFILLING**

Over the **XYLASTIC®-500** membrane on Retaining Wall, lay a layer of 25mm thick polystyrene protective board before backfilling works.

### **WARRANTY**

We warrant that the product manufactured shall be free from material defects and will be consistent with its normal high quality. Under this warranty, we will provide, at no charge, replacement of the product ex factory if this product is proven to be defective when applied, tested and cured (if applicable), in accordance with our written instructions, standards and applications recommended by us as suitable for this product.

We make no warranty as to merchantability or fitness for a particular purpose and this warranty is in lieu of all other warranties expressed or implied. The user shall determine the suitability of the product for his intended use and assume all risks and liability in connection therewith.

All claims concerning product defects must be made within nine (9) months of shipment. Absence of such claims in writing, during this period, will constitute a waiver of all claims with respect to such product.

**Note:** *The information and application advice in this data sheet is given to the best of our knowledge and no assumption can be made as to product suitability for a particular use and application.*

#### **Distributor:**



**RNC Integral Concrete Technology (M) Sdn Bhd** (Co. Reg.: 436178-D)  
37, 37-1 & 37-2 Jalan Putra Mahkota 7/7B  
Putra Heights 47650 Subang Jaya  
Selangor Darul Ehsan Malaysia  
Tel: 03-5192 8186 Fax: 03-5192 6826  
Email: [support@waterproofing.com.my](mailto:support@waterproofing.com.my)  
Website: <http://www.waterproofing.com.my>